



ABOUT US

28-year Deep In Construction Machinery Industry

Established in 1990, The Factory is one of the earliest professional manufacturers in construction machinery. With the spirit of "Being professional and doing the best", we have gradually developed into a big factory for the 20 years. We are supplying construction machinery such as Concrete Vibrator, Plate Compactor, Power Trowel, Concrete Cutter, Water Pump, Hand Insertion Vibrator, Rammer, Steel Cutter, Steel Bender, Concrete Mixer, Lifter, Concrete Screed, Vibratory Rouer and so on.

Professional and Rich Product Line

With the experience of more than 100 kinds of construction machines, we could meet your different order. Besides, our professional R&D team will work for you with the most convenient service. We could try to deliver in one month after confirming your order, and special standard products are welcomed.

Contact Us Today

Your inquiries will be answered in 24 hours. Welcome to visit our factory in Ningbo for more construction machinery to choose from. Contact us today!



CONTENTS

VIBRATORY ROLLER (振动压路机)	01
SELF-PROPELLED SCISSOR LIFTS (自行走剪叉平台)	05
RAMMER (冲击夯)	07
LIGHT TOWER (移动工程灯)	09
PLATE COMPACTOR (平板夯)	13
CONCRETE TOOLS (整平工具)	17
CONCRETE SCREED (整平机)	18
POWER TROWEL (抹平机)	19
CONCRETE CUTTER (马路切割机)	21
CONCRETE SAW (手提式切割机等)	25
TILE CUTTER (瓷砖切割机)	26
WOOD SAW (锯木机)	26
LIFTER (吊机)&BLOWEER (吹风机)	27
HYDRAULIC DUMPER (液压输送泵)	28
CONCRETE MIXER (混凝土搅拌机)	29
DUMPER (翻斗车)	34
STEEL CUTTER&BENDER (钢筋切断机 / 钢筋弯曲机)	35
ENGINE (汽油机)	39
VIBRATION MOTOR (混凝土振动器)	40
CONCRETE VIBRATOR (混凝土振动棒)	43
SPARE PARTS (接头配件)	45

CERTIFICATE





Diesel water cooled
EV80 16HP



Gasoline air cooled
Honda GX630 20HP

Features

- 1.Famous brand engine, excellent performance, easy to start-up;
- 2.Famous Italy variable pump, fixed displacement motor, stepless speed, easy to change direction;
- 3.Hydraulic diversion, efficient and convenient;
- 4.The whole machine could be controlled by instrument panel;
- 5.Comfortable driving seat;
- 6.Streamline surface, more beautiful;
- 7.Baking treated, anti-rust, anti-corrosion and beautiful;
- 8.Competitive price with good quality product.



VIBRATORY ROLLER 压路机

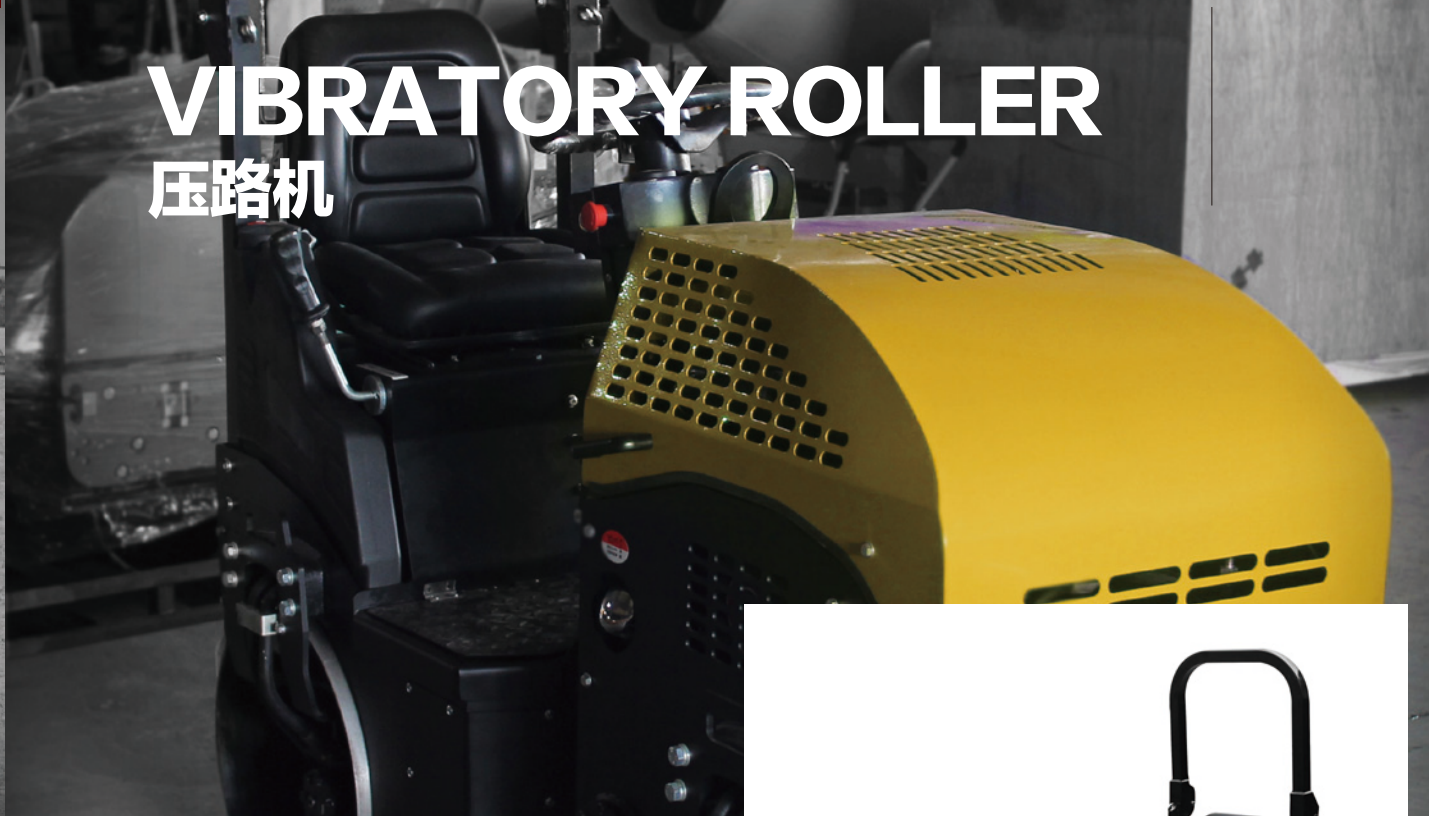

FHR-1500



Working Weight(工作重量) :1500KG
Engine(动力) :HONDA GX630/Diesel EV80
Hydraulic Pump (液压泵) : POCLAIN HYDRAULICS
Working Speed (工作速度) : 0-8KM/H
Drum Siza(钢轮尺寸) : 900*560MM
Centrifugal Force (激振力) : 21KN
Volume of Water Tank(水箱容积) : 60L
Climbing Ability (爬坡) :30°
Fuel Consumption (燃油效率) :280g/kWh
Packing Size(包装尺寸) :230CM*106CM*160CM

FHR-1000



Weight (重量) : 920KG
Power (动力) : Diesel 186F/8HP
Drive By (驱动) : Hydraulic
Starting methods (启动方式) : Electric starter
Centrifugal Force (激振力) : 20KN
Frequency (频率) : 70HZ
Working Speed (工作速度) : 0-4KM/H
Drum Size (钢轮尺寸) : 500*700MM
Climbing Ability (爬坡力) :30°
Volume of Water Tank (水箱容积) : 100L



FHR-2000



Weight(工作重量) : 1800-2000KG
Engine(动力) :HONDA GX630/Diesel EV80/YANMAR 3TNV76
Working Wide(工作宽度) : 960MM
Drum Siza(钢轮尺寸) : 900*560MM
Centrifugal Force (激振力) : 30KN
Frequency (振动频率) : 65HZ
Working Speed (工作速度) : 0-8KM/H
Climbing Ability (爬坡) :30°
Hydraulic Oil Tank(液压油容积) :30L
Volume of Water Tank(水箱容积) : 60L
Packing Size(包装尺寸) :210CM*100CM*160CM

FHR-1000 (FULL HYDRAULIC)



Weight (重量) : 920KG
Power (动力) : Diesel 186F/8HP
Drive By (驱动) : Hydraulic
Starting methods (启动方式) : Electric starter
Centrifugal Force (激振力) : 20KN
Frequency (频率) : 70HZ
Working Speed (工作速度) : 0-4KM/H
Drum Size (钢轮尺寸) : 500*700MM
Climbing Ability (爬坡力) :30°
Volume of Water Tank (水箱容积) : 100L



VIBRATORY ROLLER

压路机

FHR-600AT



Weight (重量): 680KG
 Power (发动机功率): Diesel Water-Cooled 9HP or Honda GX390 13HP
 Start Method (启动方式): Electric Starter (电启动)
 Frequency (发动机转速): 2400RPM/3300RPM
 Centrifugal Force (激振力): 20KN
 Max. Travailing Speed (最大行驶速度): 3KM/H
 Climbing Capacity (爬坡能力): 20°
 Water Tank Capacity (水箱容量): 40L
 Hydraulic Oil Tank Capacity (液压油箱容量): 25L
 Turning radius (转弯半径): 20°
 Drum Size (轮子尺寸): 370*650MM/420*650MM
 Packing Size (包装尺寸): 130*75*130CM



FHR-600A/700A



Weight (重量): 640KG/730KG
 Power (发动机功率): Diesel Water-Cooled 9HP or Honda GX390 13HP
 Start Method (启动方式): Electric Starter (电启动)
 Frequency (发动机转速): 2400RPM/3300RPM
 Centrifugal Force (激振力): 20KN/24KN
 Max. Travailing Speed (最大行驶速度): 3KM/H
 Climbing Capacity (爬坡能力): 20°
 Water Tank Capacity (水箱容量): 40L
 Hydraulic Oil Tank Capacity (液压油箱容量): 25L
 Drum Size (轮子尺寸): 370*650MM/420*650MM
 Packing Size (包装尺寸): 127*74*108CM/147*73*113CM

FHR-600



Weight (重量): 300KG
 Engine Optional (动力选择): Honda GX160, Robin EY20, Lifan, Loncin
 Engine Power (动力功率): 5-5.5HP
 Centrifugal Force (离心力): 15KN
 Walking Speed (行驶速度): 2.4-4.0KM/H
 Frequency (发动机频率): 70HZ
 Drive Method (驱动方式): Static Hydraulic Drive Unit (液压)
 Vibration (振动方式): Mechanical (机械)
 Climbing Capacity (爬坡能力): 25%
 Water Tank Capacity (水箱容量): 15L
 Drum Size (轮子尺寸): 450*600MM
 Packing Size (包装尺寸): 86*98*105CM



FHR-600D



Weight (重量): 640KG
 Centrifugal Force (激振力): 20KN
 Power (发动机功率): Gasoline Honda GX270 9HP
 Max. Travailing Speed (最大行驶速度): 4KM/H
 Frequency (发动机频率): 70Hz
 Climbing Capacity (爬坡能力): 25%
 Water Tank Capacity (水箱容量): 30L
 Drum Size (轮子尺寸): 450*600MM
 Packing Size (包装尺寸): 150*88*102CM



FHR50A



Weight (重量): 50KG
 Working Width (工作宽度): 300MM
 Power (发动机功率): Gasoline Engine 3HP
 Certification Force (激振力): 5KN
 Working Speed (行驶速度): 0-4KM/H
 Volume of Water Tank (水箱容量): 10L



SELF-PROPELLED SCISSOR LIFTS

自行走剪叉平台

- Zero-emission electric operation
- 零排放电力操作
- Front-wheel drive and zero inside turning radius
- 前轮 90 度转向系统无需旋转半径提供了优良的操纵性
- 39 in (1 m) roll-out platform extension on GS-2646
- (39 英寸 (1 米) 的平台扩展范围)
- Folding rails with full-height swing gate
- 承载力强的钢制方管护栏无需工具快速向下折而通过单门通道
- Universal 20 amp smart charger
- 20 安培智能充电
- Proportional controls for lift and drive functions
- 升高和驾驶皆采用比例控制
- Multiple disc brakes provide smooth deceleration
- 多片盘刹使减速平稳
- On-board diagnostics for easy troubleshooting
- 作业车上的故障诊断装置能将可能存在的错误情况通知操作者
- Emergency stop at both platform and ground controls
- 升降平台和地面控制器上均装有紧急停止开关
- Solid, non-marking tires
- 无痕轮胎
- Manual platform lowering valve
- 倾斜传感器
- Tilt sensor with an audible alarm
- 蜂鸣警报器



FHPT-2646



Working height maximum (最大工作高度) : 9.8m

A Platform height maximum (最大平台高度) : 7.8m

B Platform height – stowed (平台高度 – 收缩时) : 1.16m

C Platform length – outside (平台 – 外侧长度) : 2.26m
Extended (延伸长度) : 3.18m

Slide-out platform extension deck (延长甲板) : 0.96m

D Platform width – outside (平台宽度 – 外侧) : 1.15m

Toeboard height (踢脚板高度) : 0.15m

E Height – stowed (高度 – 收缩时) : 2.26m

rails lowered (折叠护栏) : 1.68m

F Length – stowed (长度 – 收缩时) : 2.41m

platform extended (长度 – 升高时) : 3.33m

G Width (宽度) : 1.17m

H Wheelbase (轴距) : 1.85m

I Ground clearance – center (离地间隙 – 中心) : 0.1

Maximum platform occupancy (最多容纳人数) : 2 person

Lift capacity (载重能力) : 454kg

Extension deck capacity (延伸平台载重) : 136kg

Drive speed – stowed (行驶速度 – 收缩时) : 3.5km/h

Drive speed – raised (行驶速度 – 升高时) : 0.8km/h

Gradeability – uphill stowed (爬坡能力 – 收缩时) : 30%

Turning radius – outside (转弯半径) : 2.29m

Raise/lower speed (升降速率) : 30/38 second

Non-marking tires – rough terrain (无痕轮胎尺寸) : 38 x 13 x 28cm

Power source (动力源) : 48V DC (Four 6V batteries, 225 Ah capacity)

Hydraulic system capacity (液压系统容量) : 17L

Weight (重量) : 2447kg

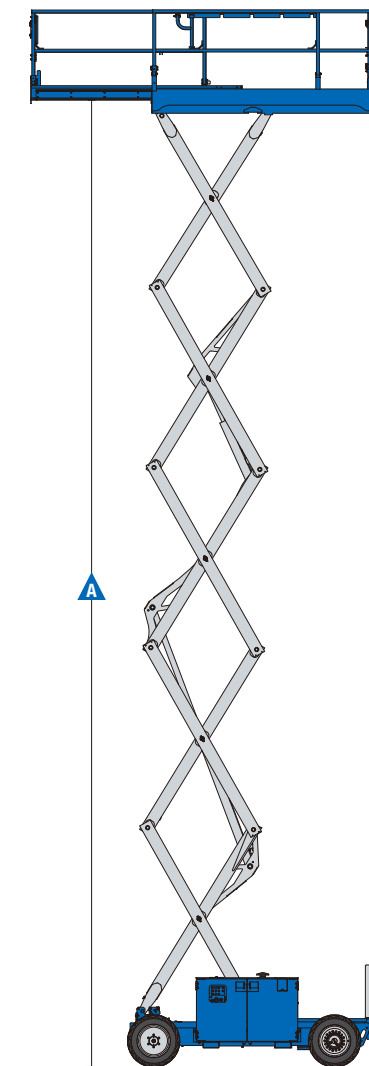
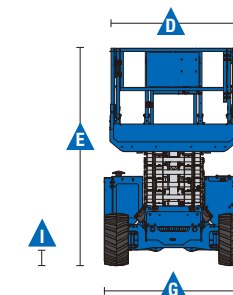
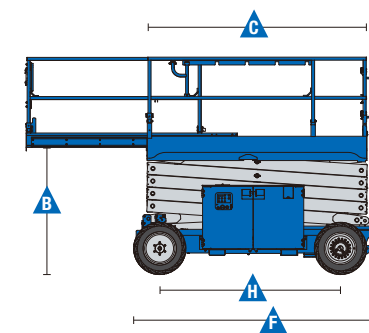

RAMMER/ 冲击夯

4-cycle Gasoline Engine.
Double Cleaner System
Optional
Chinese engine, economical and practical
Original Japanese engine, high quality and long life time
Trolley, good choice for easy transportation

80K-100 CE

Weight (重量) : 75KG
Bounding Height (振动高度) : 50-80MM
Impact Force (冲击力) : 16.5KN
Impact Frequency (冲击频率) : 645-700/MIN
Compacted Depth (压实深度) : 0.55M
Plate Size (底板尺寸) : 285*340MM
Engine Model (动力型号) : Gasoline Honda GX100 3HP
Packing Size (包装尺寸) : 75*42*112CM



80H CE

Engine Type (动力) : Petrol,Diesel
Power(马力) : 4.0(5.5)HP
Operation Mass kg(lbs) (重量) : 70(164)
Percussion Rate per min (冲击次数 / 分) : 650-695
Impact Force (激振力) : 14KN
Jumping Stroke (跳高) : 40-85mm
Fuel Tank Capacity (油箱容积) : 2.8L
Shoe Size: 330*285mm(13*11in)
Dimension: 46*76*114CM



80C CE

Engine Type (动力) : Petrol,Diesel
Power(马力) : 4.0(5.5)HP
Operation Mass kg(lbs) (重量) : 68(149)
Percussion Rate per min (冲击次数 / 分) : 650-695
Impact Force (激振力) : 13KN
Jumping Stroke (跳高) : 40-85mm
Fuel Tank Capacity (油箱容积) : 2.8L
Shoe Size: 330*285mm(13*11in)
Dimension: 43*76*114CM



SPARE PARTS CE



80R CE

Weight (重量) : 80KG
Bounding Height (振动高度) : 55-70MM
Impact Force (冲击力) : 11KN
Impact Frequency (冲击频率) : 650/MIN
Compacted Depth (压实深度) : 0.55M
Engine Model (动力型号) : Chinese Engine 6.5HP
Packing Size (包装尺寸) : 61*52*97CM





FHZM-T



Weight: 550KG
Power * Lamp quantity: 1000W*4 Metal halide lamp
Luminous Flux: 440000LM
Elevating Height: 700mm by hand-operated
Anti-wind capacity: less 6 grade
Diesel Engine: Air-cooled 186F, diesel engine
Power: 6KW
Working time: 42-45H
Type: Single phase generator
Frequency: 50HZ
The main part: 189*168*160CM
Lamp post: 336*46*38CM
Lamp: 116*96*33CM
Shipping size: 218*113*230CM



METAL
HALIDE LAMP



FHZM-1



Weight (重量) : 350KG
Generator Set (发电机组) : Diesel 5KW
Rated Voltage (额定电压) : 220V
Power Rating (额定功率) : 5KW
Power*Lamp Quantity (灯泡瓦数) : 400W*4 Metal Halide Lamp
Max Height (最大高度) : 5M
Continuous Working Time (持续工作时间) : 12H
Fuel Tank Capacity (油箱容量) : 15L
Anti-wind Capacity (有效容量) : less 6 grade
Walking Method (行走方式) : Hand-push type 手推

FHZM-T9



Weight: 960KG
Power * Lamp quantity: 1000W*4 Metal halide lamp
Luminous Flux: 440000LM
Elevating Height: 900mm by hand-operated
Anti-wind capacity: less 6 grade
Diesel Engine: LAIDONG DIESEL 3800 / KUBATO D1105
Power: 8KW
Working time: 120H
Type: Single phase generator
Frequency: 50HZ
Insulation grade: H
Degree of Deviation: less than 10
Lamp post: 336*46*38CM
Lamp: 116*96*330CM
Size: 436*143*145CM



LIGHT TOWER/ 移动照明灯

NINGBO FEIHU MACHINERY CO.,LTD

FHZM-2



Weight (重量): 230KG
Generator Set (发电机组): 2500/Diesel
Rated Voltage (额定电压): 220V
Power Rating (额定功率): 2.5KVA
Max. Output (最大输出功率): 2.8KW
Continuous Working Time (持续工作时间): 6H
Fuel Tank Capacity (油箱容量): 15L
Power*Lamp Quantity (灯泡瓦数): 100W*4
Max Height (最大高度): 5M
Elevating Range (升降范围): 2300-4800MM by hand-operated
Anti-wind Capacity (有效容量): less 6 grade
Walking Method (行走方式): Hand-push type 手推



LED

METAL
HALIDE LAMP



MANUAL LIFTING

FHZM-3



Weight (重量): 280KG
Generator Set (发电机组): 6GF-LED
Rated Voltage (额定电压): 220V
Frequency (频率): 60Hz
Rated Power (额定功率): 4.8KW
Max. Output (最大输出功率): 5.5KW
Dc Output (直流输出): 12V/8.3A
Power*Lamp Quantity (灯泡瓦数): 1000W*4
Max Height (最大高度): 5M
Anti-wind Capacity (有效容量): less 6 grade
Walking Method (行走方式): Hand-push type 手推
Lifting Method (升降方式): Manual(Air pressure is optional) 手动 (气压)

FHZM-4 C €

Weight (重量): 310KG
Generator Set (发电机组): Diesel 5KW
Rated Voltage (额定电压): 220V
Power Rating (额定功率): 5KW
Continuous Working Time (持续工作时间): 12H
Fuel Tank Capacity (油箱容量): 15L
Power*Lamp Quantity (灯泡瓦数): 1000W*2 Metal Halide Lamp
Max Lifting Height (最大上升高度): 5M
Anti-wind Capacity (有效容量): less 6 grade
Walking Method (行走方式): Hand-push type 手推



METAL
HALIDE LAMP



PLATE COMPACTOR

平板夯

C-95



Weight (重量) : 90KG
Engine Optional (发动机品牌) : Honda GX160, Robin EY20, Lifan, Loncin
Engine Power (发动机功率) : 5-5.5HP
Frequency (发动机转速) : 3600R.P.M
Centrifugal Force (离心力) : 17.8KN
Compact Depth (压实深度) : 300MM
Working Efficiency (工作效率) : 650 m² /H
Travel Speed (行驶速度) : 20-25M/MIN
Plate Size (底板尺寸) : 51.5*50CM
Packing Size (包装尺寸) : 65*52*62CM



C-100



Weight (重量) : 100KG
Engine Optional (发动机品牌) : Honda GX160, Robin EY20, Lifan, Loncin
Engine Power (发动机功率) : 5-5.5HP
Frequency (发动机转速) : 3600R.P.M
Centrifugal Force (离心力) : 19.8KN
Compact Depth (压实深度) : 350MM
Working Efficiency (工作效率) : 750 m² /h
Travel Speed (行驶速度) : 22-25M/MIN
Plate Size (底板尺寸) : 58*48CM
Packing Size (包装尺寸) : 75*50*70CM



Features

Good quality, fully complied with CE, GS, EPA Directive
Foldable handle for easy transportation and stock. (straight handle is also available)
Open plate provides self cleaning
Complete sealed belt cover to prevent sand and soil in.
Radius base plate for easy access to corners
Throttle control for easy holding working speed. (Throttle control is available as optional)
Heavy-duty shock mounts reduce vibration to the upper engine and handle

C-90-1/2/3



Weight (重量) : 85KG
Power (功率) : Gasoline Engine 5-5.5HP
Frequency (发动机转速) : 3600R.P.M
Impact Force (冲击力) : 15.3KN
Travel Speed (行驶速度) : 20-25M/MIN
Limited Grade Ability (爬坡能力) : 20°
Plate Size (底板尺寸) : 55*42CM
Packing Size (包装尺寸) : 57*46*70CM



C-180



Compact Depth (压实深度) : 350MM
Travel Speed (行驶速度) : 0-25M/MIN
Engine Power (功率) : 7.5-9HP
Vibratory Frequency (振动频率) : 5000TIMES/MIN
Centrifugal Force (离心力) : 27KN
Plate Size (底板尺寸) : 69*48CM
Weight (重量) : 140KG
Packing Size (包装尺寸) : 77*47*96CM



C-330



Compact Depth (压实深度) : 600MM
Travel Speed (行驶速度) : 0-25M/MIN
Engine Power (功率) : 10-13HP
Vibratory Frequency (振动频率) : 3600TIMES/MIN
Centrifugal Force (离心力) : 40KN
Plate Size (底板尺寸) : 90*68CM
Weight (重量) : 270KG
Packing Size (包装尺寸) : 104*71*105CM



PLATE COMPACTOR/ 平板夯



C-60-1



Weight (重量) : 60KG
Power (功率) : Gasoline Engine 5-5.5HP
Frequency (发动机转速) : 3600 R.P.M
Impact Force (冲击力) : 10KN
Travel Speed (行驶速度) : 20-25M/MIN
Limited Grade Ability (爬坡能力) : 20°
Plate Size (底板尺寸) : 51*35CM
Packing Size (包装尺寸) : 60*40*56CM



C-120



Weight (重量) : 94KG
Power (功率) : Gasoline Engine 5-5.5HP
Frequency (发动机转速) : 3600R.P.M
Impact Force (冲击力) : 17KN
Travel Speed (行驶速度) : 20-25M/MIN
Limited Grade Ability (爬坡能力) : 20°
Plate Size (底板尺寸) : 60*48CM
Packing Size (包装尺寸) : 61*54*62CM



C-60-2



Weight (重量) : 60KG
Power (功率) : Gasoline Engine 5-5.5HP
Frequency (发动机转速) : 3600 R.P.M
Impact Force (冲击力) : 10KN
Travel Speed (行驶速度) : 20-25M/MIN
Limited Grade Ability (爬坡能力) : 20°
Plate Size (底板尺寸) : 51*35CM
Packing Size (包装尺寸) : 70*40*56CM



C-140-1



Weight (重量) : 97KN
Power (功率) : Gasoline Engine 5-5.5HP
Frequency (发动机转速) : 3600R.P.M
Impact Force (冲击力) : 16KN
Travel Speed (行驶速度) : 20-25M/MIN
Limited Grade Ability (爬坡能力) : 20°
Plate Size (底板尺寸) : 60*50CM
Packing Size (包装尺寸) : 65*56*72CM



C-70/C-70W



Weight (重量) : 75KG
Power (发动机功率) : Gasoline Engine5-5.5HP
Frequency (发动机转速) : 3600 R.P.M
Impact Force (冲击力) : 13.5KN
Travel Speed (行驶速度) : 15-20M/MIN
Limited Grade Ability (爬坡能力) : 20°
Plate Size (底板尺寸) : 57*43CM
Packing Size (包装尺寸) : 77*52*74CM



C-140-2



Weight (重量) : 97KG
Power (功率) : Gasoline Engine 5-5.5HP
Frequency (发动机转速) : 3600R.P.M
Impact Force (冲击力) : 17.5KN
Travel Speed (行驶速度) : 20-25M/MIN
Limited Grade Ability (爬坡能力) : 20°
Plate Size (底板尺寸) : 61*46CM
Packing Size (包装尺寸) : 64*48*65CM



C-80



Weight (重量) : 80KG
Power (功率) : Gasoline Engine5-5.5HP
Frequency (发动机转速) : 3600 R.P.M
Impact Force (冲击力) : 14.5KN
Travel Speed (行驶速度) : 15-20M/MIN
Limited Grade Ability (爬坡能力) : 20°
Plate Size (底板尺寸) : 51*37CM
Packing Size (包装尺寸) : 72*44*70CM



C-160



Weight (重量) : 100KG
Power (功率) : Gasoline Engine 5.5HP
Frequency (发动机转速) : 3600R.P.M
Impact Force (冲击力) : 18KN
Travel Speed (行驶速度) : 20-25M/MIN
Limited Grade Ability (爬坡能力) : 30°
Plate Size (底板尺寸) : 50*58.5CM
Packing Size (包装尺寸) : 80*53*53CM

CONCRETE TOOLS 整平工具



ALUMINUM MAGNESIUM ALLOY

HANDLE LENGTH: 1.8 – 5.4M (NORMALLY 5.4M) * 45MM
BLADE SIZE: 20CM (WIDE) * 80–300CM(LONG)
BLADE SICKNESS: 22MM

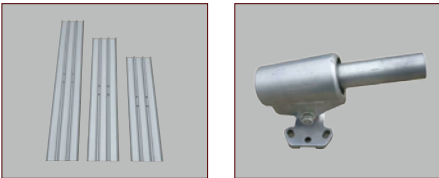

STAINLESS STEEL

HANDLE LENGTH: 1.8 – 5.4M (NORMALLY 5.4M) * 45MM
BLADE SIZE: 30CM (WIDE) * 120CM(LONG)
BLADE SICKNESS: 1.8MM

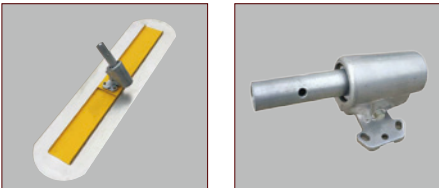

MANGANESE STEEL

HANDLE LENGTH: 1 – 4.5M (NORMALLY 4.5M) * 32MM
BLADE SIZE: 15CM (WIDE) * 70CM–120CM(LONG)
BLADE SICKNESS: 1.5MM



ALUMINUM MAGNESIUM ALLOY

HANDLE LENGTH: 1.8 – 5.4M (NORMALLY 5.4M) * 45MM
BLADE SIZE: 300CM(LONG)

CONCRETE SCREED/ 整平机



S-1



Weight (重量) : 8–21KG
Power (功率) : Gasoline Engine 2HP
Blade Size (刀片尺寸) : 1–5M
Packing Size (包装尺寸) : 116*46*30CM



S-5



Weight (重量) : 8–21KG
Power (功率) : Gasoline Engine 2HP
Blade Size (刀片尺寸) : 1–5M
Packing Size (包装尺寸) : 101*38*29CM

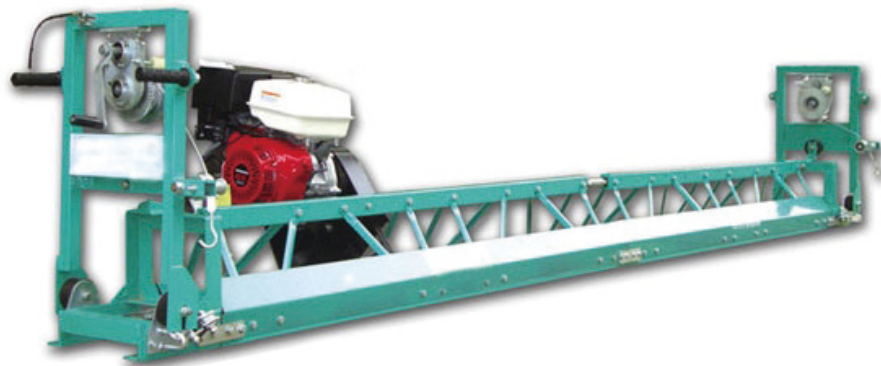

Model(发动机)	FHZP55X(< =)5500mm		FHZP90X(< =)8500mm	FHZP130X(>=)9000mm
Tap				
Nominal amplitude (名义振幅)	0.6mm			
Vibration frequency (名义振幅)	70Hz			
Centrifugal force (名义振幅)	11kN/(< =)2000mm			
Engine(发动机)				
Model (型号)	HONDA GX160	HONDA GX270	HONDA GX390	
Type (类型)	Gasoline engine, air-cooled 4-stroke, OHV, single cylinder			
Power (功率)	5.5hp/3600rpm	9.0hp/3600rpm	13.0hp/3600rpm	
Fuel tank capacity (油箱容量)	3.6L	6L	6.5L	
Lubricant (润滑油容量)	0.6L	1.1L		
Fuel consumption (耗油量)	313g/kWh			
Dimensions (尺寸)				
Two meters combination Festival (2 米组合尺寸)	405mm × 2000mm			
One meter combination Festival(1 米组合尺寸)	405mm × 1000mm			
Half a meter combination Festival (半米组合尺寸)	405mm × 250mm			
Note: When ordering, you should buy a length of about 500mm width greater than construction machines				

POWER TROWEL/ 抹平机

Features

Over-built gearbox assure long service life
Heavy-weight design to assure a superior finish
Safety designed guard ring
Height adjustable handle, assures operator comfort & easy control

Optional
Finishing blade
Pan
Different handles

Ride On Power Trowel F83

Weight(重量) : 245KG.
Power (动力) : Honda 13HP
Blade (刀片) :8PCS
Blade Speed RPM (转速) : 75-150
Path Width (宽度) :156CM
Dimension (尺寸) : 170* 90*70CM



Ride On Power Trowel F96

Weight (重量) : 372KG
Power (功率) : Gasoline Engine 20HP
Blade (刀片) : 8pcs
Path Width (工作宽度) : 236CM
Packing Size (包装尺寸) : 205*114*110CM



POWER TROWEL PLATE



POWER TROWEL BLADE



35CM*20CM



22.5CM*12CM



35CM*15CM



22.5CM*20CM

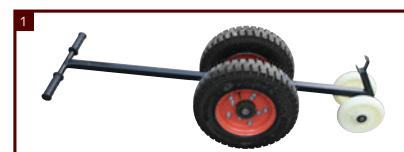

BPM80

Weight (重量) : 74KG
Diameter (直径) : 800MM
Driving Speed (行驶速度) : 50-100R.P.M
Power (功率) : Gasoline Engine 5-5.5HP
Blade Dimension (刀片尺寸) : 265*150MM
Packing Size (包装尺寸) : 80*80*42CM(Body)
40*40*43CM(Engine)

BPM100

Weight (重量) : 76KG
Burnishing Plate Diameter (抹盘直径) : 1000MM
Revolving Speed of Burnishing Plate(抹盘旋转速度) : 60-165R.P.M
Engine Optional (发动机品牌) :
Honda GX160, Robin EY20, Lifan, Loncin
Power/ 功率 : 5-5.5HP
Blade Dimension (刀片尺寸) : 350*150MM
Packing Size (包装尺寸) : 99*99*35CM(Body)
40*40*43CM(Engine)

BPM120

Weight (重量) : 80KG
Diameter (直径) : 1200MM
Driving Speed (转速) : 60-165R.P.M
Power (功率) : Gasoline Engine 7.5-9HP
Blade Dimension (刀片尺寸) : 410*150MM
Packing Size (包装尺寸) : 122*122*36CM(Body)
52*46*48CM(Engine)

BPM60

Weight (重量) : 65KG
Diameter (直径) : 600MM
Driving Speed (转速) : 60-165R.P.M
Power (功率) : Gasoline Engine 5-5.5HP
Blade Dimension (刀片尺寸) : 220*120MM
Packing Size (包装尺寸) : 65CM × 65CM × 80CM

CONCRETE

马路切割机



25A €

Weight (重量) : 123KG
Incise Depth (切割深度) : 70-125MM
Linear Velocity of Sawing Blade (切割速度) : 90M/S
Engine Optional (发动机品牌) : Honda GX390, Kohler, Lifan, Loncin
Power (功率) : 13-14HP
Max Sawing Blade (刀片直径) : 450MM(18inch)
Water Tank Capacity (水箱容量) : 45L
Blade Bore Diameter (刀片内径) : ϕ 27
Packing Size (包装尺寸) : 110*55*92CM

35A €

Weight (重量) : 140KG
Incise Depth (切割深度) : 185MM
Linear Velocity of Sawing Blade (切割速度) : 90M/S
Power (功率) : Gasoline Engine 7.5-9HP
Rated Speed (发动机转速) : 3600R.P.M
Water Tank Capacity (水箱容量) : 25L
Max Sawing Blade (刀片直径) : 450MM(18inch)
Packing Size (包装尺寸) : 97*58*95CM
Packing Size (包装尺寸) : 110*55*92CM

concrete cutter

CONCRETE CUTTER/马路切割机

Features

Super-rigid box frame ensures straight cuts while resisting warping and vibration—prolongs saw life
Easy crank for raising/lowering cutting depth
Rustless water tank provides an optimum flow and volume of water to the blade
Throttle control as standard part

Features

Super-rigid box frame ensures straight cuts while resisting warping and vibration—prolongs saw life
Easy crank for raising/lowering cutting depth
Large water tank provides an optimum flow and volume of water to the blade
Throttle control as standard part
Hinged front, lift-up blade guard is designed to provide easy blade replacement.

concrete cutter



10A €

Weight (重量) : 87KG
Incise Depth (切割深度) : 100MM
Linear Velocity of Sawing Blade (切割速度) : 90M/S
Power (功率) : Gasoline Engine 5–5.5HP
Rated Speed (发动机转速) : 3600R.P.M
Water Tank Capacity (水箱容量) : 15L
Max Sawing Blade (刀片直径) : 350MM(14inch)
Packing Size (包装尺寸) : 83*52*82CM



13A €

Weight (重量) : 53KG
Incise Depth (切割深度) : 80–105MM
Linear Velocity of Sawing Blade (切割速度) : 90M/S
Engine Optional (发动机品牌) : Honda GX160, Robin EY20, Lifan, Loncin
Power (功率) : 5–5.5HP
Max Sawing Blade (刀片直径) : 350MM(14inch)
Water Tank Capacity (水箱容量) : 12L
Blade Bore Diameter (刀片内径) : ϕ 27
Packing Size (包装尺寸) : 82*52*80CM



20A €

Weight (重量) : 100KG
Incise Depth (切割深度) : 160MM
Linear Velocity of Sawing Blade (切割速度) : 90M/S
Power (功率) : Gasoline Engine 7.5–9HP
Rated Speed (发动机转速) : 3600R.P.M
Water Tank Capacity (水箱容量) : 25L
Max Sawing Blade (刀片直径) : 400MM(16inch)
Packing Size (包装尺寸) : 96*60*80CM



60A €

Weight (重量) : 127KG
Incise Depth (切割深度) : 180MM
Linear Velocity of Sawing Blade (线切割速度) : 90M/S
Power (功率) : Gasoline Engine 13HP
Rated Speed (发动机转速) : 3600R.P.M
Water Tank Capacity (水箱容量) : 32L
Max Sawing Blade (刀片直径) : 450MM(18inch)
Packing Size (包装尺寸) : 110*51*82CM



30A €

Weight (重量) : 140KG
Incise Depth (切割深度) : 185MM
Power (功率) : Gasoline Engine 7.5–9HP
Rated Speed (发动机转速) : 3600R.P.M
Water Tank Capacity (水箱容量) : 25L
Max Sawing Blade (刀片直径) : 400MM(16inch)
Packing Size (包装尺寸) : 97*60*90CM



70A €

Weight (重量) : 175KG
Incise Depth (切割深度) : 180MM
Power (功率) : 20HP
Rated Speed (发动机转速) : 3600R.P.M
Water Tank Capacity (水箱容量) : 39L
Drive Mechanism (传动机构) : Gear Type (齿轮式)
Max Sawing Blade (刀片直径) : 600MM
Packing Size (包装尺寸) : 122*67*105CM



CONCRETE SAW 手提式切割机



DS350

Engine (动力) : 1E50F, air cooling, 2-stroke
Displacement : 71CC
Maximum power (最大马力) : 3.2KW/4.5HP
Idle Speed (空载转速) : 5400rpm
Blade Speed (刀片转速) : 9400rpm
Fuel tank Capacity (油箱容积) : 700ml
Blade Diameter (刀片尺寸) : 350mm(14")
Max. Cutting Depth (最大切割深度) : 125mm
G.W/N.W : 15/13KGS(with blade)
Packing Size (包装尺寸) : 660X270X460mm
Loading Amount (装柜数据) : 360PCS/20GP

TILE CUTTER 瓷砖切割机

CQ350/CQ350E

Power (马力) : Gasoline Engine 5.0~5.5HP
Or Single Phase Motor (单相电压) : 220V
Outer Diameter (外径) : 350MM
Bore (口径) : 20MM
Rip Cut (切口) : 400MM
Depth of Cut (切割深度) : 120MM
Table Size (工作台尺寸) : 990*430MM
Packing Size (包装尺寸) : 118*57*96CM/116*55*85CM



POWER STATION 液压动力站

ST13-30

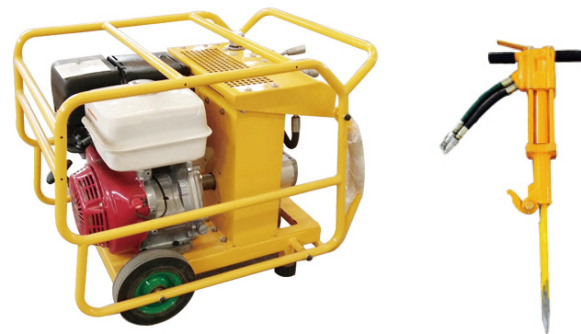

L.P.M: 20-30l.p.m
MAX PRESSURE (最大压强) : 155bar
HYDRAULIC OIL (液压油) : 12L
ENGINE (动力) : HONDA GX390
HP (马力) : 13hp/3600rpm
OIL TANK (油箱) : 6.5L
LUBRICATING OIL (液压油箱) : 1.1L
FUEL CONSUMPTION (燃油效率) : 313g/KWh
MACHINE SIZE (尺寸) : 799X713X770mm
PACKAGE (包装尺寸) : 880X775X770mm
WORKING WEIGHT (工作重量) : 115kg
MAX WORKING WEIGHT (最大工作重量) : 160kg

SHREDDER CHIPPER 碎枝机

FHS-15



Feed Size (进料尺寸) : ≤ 100MM
Output Size (出料尺寸) : 3.5MM
Capacity (运行能力) : 5-8m³/h
Power (马力) : 5.5HP/9HP/13HP/7KW
Weight (重量) : 100KG - 150KG
Chipping blades (刀片) : 1PCS
Chipping hammers (刮条) : 16PCS Hitch Trailer



shredder chipper

MILLING MACHINE 铣刨机

XP250E/XP250G



Weight (重量) : 200KG. / 178KG
Power (动力) : 7.5KW / Honda 13HP
Wide (宽度) : 250MM
Deep (深度) : 5-8MM
Blade Shaft (刀轴) : 6
Blade (刀片) : 108PCS
Working Speed (工作效率) : 46-70M²/H
Dimension (尺寸) : 99* 55*98CM

WOOD SAW 锯木机

JB-400/JB-500

Motor Power (电机功率) : 3KW/4KW
Hob Diameter (滚刀直径) : 400MM/500MM
Running Speed (运行速度) : 1800RPM/2800RPM
Weight (重量) : 65KG/100KG
Packing Size (包装尺寸) : 77*57*73CM



LIFTER

吊机



JF300/JF500

Lifting Capacity (提升能力): 300KG/500KG
Lifting Speed (提升速度): 12m/min
Motor Power (电机功率): 2.2KW~4KW
Voltage (电压): 220V/380V
Length of wire rope (钢丝绳长度): 20m
Diameter of wire rope (钢丝绳直径): 4mm
Weight (重量): 100KG

ROAD BLOWER

路面吹尘机



CF-55

Blade diameter (叶片尺寸): 280mm
Blade rotational speed (叶片转速): 3600rpm
Air velocity (空气流量): 5000m³/h
Blow-off nozzle (吹风原理): Single blow-off nozzle, adjustable
Model (动力): HONDA GX160
Power (马力): 5.5hp/3600rpm
Oil tank volume (燃料箱): 3.6L
Fuel consumption (燃料消耗): 313g/Kwh
Total length (总长): 1130mm
Packing size (包装尺寸): 870×750×580mm
Weight (重量): 68kg

CONCRETE PUMP/ 液压输送泵



Model (型号)		HBTS80.13-90E	HBTS80.16-110E	HBTS80.13-130R	HBTS40-12-55	HBTS30-10-45	HBTS25-8-37
Max. Theoretic Conveying Capacity (理论最大输送能力)		81m³/h	81 m³/h	88m³/h	40m³/h	30m³/h	25m³/h
Max. Theoretic Conveying Pressure (理论最大输送压力)		13Mpa	16Mpa	13Mpa	12Mpa	10Mpa	8Mpa
Concrete Cylinder(Bore X Stroke) (钢筒混凝土管 缸径 X 行程)		Φ200/1800mm	Φ200/1800mm	Φ200/1600mm	Φ180*1000	Φ160*1000	Φ140*750
Feeding Hopper Capacity (给料斗容量)		680L	680L	680L	0.4m³/1100mm	0.4m³/1100mm	0.3m³/1100mm
Diameter of Discharging Gate (卸料门直径)		180mm	180mm	180mm	120-230mm	120-230mm	120-230mm
Power (功率)		90Kw	110Kw	130KW	55KW	45KW	37KW
Power Type (动力类型)		Electric Motor	Electric Motor	DEUTZ Diesel engine	Electric Motor	Electric Motor	Electric Motor
Brand of Main Oil Pump (主油箱品牌)		German Rexroth (Japanese Kawasaki)	German Rexroth (Japanese Kawasaki)	German Rexroth (Japanese Kawasaki)	Japanese Kawasaki	Japanese Kawasaki	Japanese Kawasaki
Main Cylinder Bore x Stroke (主油缸 缸径 X 行程)		Φ125/1800mm	Φ140/1800mm	Φ140/1600mm	Φ180*1000mm	Φ160*1000mm	Φ140*750mm
Capacity of Hydraulic Oil Tank (液压油箱容量)		580L	580L	580L	200L	200L	200L
Rated Conveying Distance (额定输送距离)	Vertical (垂直)	280m	360m	360m	180m	150m	130m
	Horizontal (水平)	1200m	1600m	1600m	600m	500m	400m
Total Weight (总重)		6000Kg	6200Kg	6480Kg	3200kg	3000kg	2500kg
Overall Dimension (L X W X H) (外形尺寸)		6200*2160*2600mm	6200*2160*2600mm	6000*2160*2600mm	4500*1500*1800mm	4500*1500*1800mm	4400*1450*1700mm

CONCRETE MIXER/ 混凝土搅拌机



JZC350DH/JZC500DH

Weight (重量) 1600kg
In Capacity (内容) : 560L
Out Capacity (外容) : 350L
Productivity (生产力) : 14m³/H
Engine (马达) : Diesel Yanmar 18HP
Power of Water Pump (水泵功率) : 0.75kw
Pressure of Gear Pump (齿轮泵压力) : 20Mpa
Accuracy of Water Supply Error (供水精度误差) : ≤ 2%
Max Trailing Speed (最大运行速度) : 20km/h
Tyre Size (轮胎尺寸) : 6.50-16
Speed of Mixing Drum (滚筒转速) : 14RPM
Lifting Methods (吊装方法) : Hydraulic Tipping Hopper
Container Loading: 2 Sets Per 20GP, 6 Sets Per 40HQ



JZC350DW/JZC500DW

Weight (重量) 1600kg
In Capacity (内容) : 560L
Out Capacity (外容) : 350L
Productivity (生产力) : 14m³/H
Engine (马达) : Diesel Yanmar 18HP
Power of Water Pump (水泵功率) : 0.75kw
Pressure of Gear Pump (齿轮泵压力) : 20Mpa
Accuracy of Water Supply Error (供水精度误差) : ≤ 2%
Max Trailing Speed (最大运行速度) : 20km/h
Tyre Size (轮胎尺寸) : 6.50-16
Speed of Mixing Drum (滚筒转速) : 14RPM
Lifting Methods(吊装方法) : Mechanism Tipping Hopper(钢索)
Container Loading: 2 Sets Per 20GP, 5 Sets Per 40HQ

JZC350EH/JZC500EH

Weight (重量) : 1450KG
In Capacity (内容) : 560L
Out Capacity (外容) : 350L
Productivity (生产力) : 14m³/H
Motor Model (电机型号) : Y132S-4-B3 5.5KW
Motor Speed (电机速度) : 1440R.P.M.
Power Supply (电机类型) : Three Phase, 380V/50HZ
Motor for Mixing (搅拌电机) : 4KW
Motor for Tipping (升降电机) : 2.2KW
Drum Dimension (滚筒尺寸) : 1560MM × 1890MM
Drum Rotation Speed (滚筒转速) : 14.5/MIN
Wheel Tyre Size (轮胎尺寸) : 6.50-16
Max Driving Speed (最大行驶速度) : 20KM/H
Lifting Methods(吊装方法) : Hydraulic Tipping Hopper(液压)
Container Loading: 2 Sets Per 20GP, 6 Sets Per 40HQ



JZC350EW/JZC500EW

Weight (重量) : 1350KG
In Capacity (内容) : 560L
Out Capacity (外容) : 350L
Productivity (生产力) : 14m³/H
Motor Model (电机型号) : Y132S-4-B3 5.5KW
Motor Speed (电机速度) : 1440R.P.M.
Power Supply (电机类型) : Three Phase, 380V/50HZ, 5.5KW
Drum Dimension (滚筒尺寸) : 1560MM × 1890MM
Drum Rotation Speed (滚筒转速) : 14.5/MIN
Wheel Tyre Size (轮胎尺寸) : 6.50-16
Max Driving Speed (最大行驶速度) : 20KM/H
Lifting Methods (吊 装 方 法) : Mechanism Tipping Hopper (钢索)
Container Loading: 2 Sets Per 20GP, 5 Sets Per 40HQ



CONCRETE MIXER/ 混凝土搅拌机



FHC-500

Weight (重量) : 700KG
Power (马力) : Diesel 186F
Drum Capacity (滚筒容积) : 500L
Drum Running Speed (滚筒转速) : 100RPM
Packing Size (尺寸) : 210*160*150CM



JH300/JH500

Weight (重量) : 200KG/300KG
Volume(体积) : 300L/500L
Mixing time(搅拌时间) : 6-8 minutes
Ration rate(配比率) : 63RPM
Equipped with power(动力) : 2.2KW/3KW 380V
Packing Size(尺寸) : 210*70*145CM



JC600

Weight (重量) : 281KG
Power (马力) : 380V 4KW / R180 DIESEL
Drum Capacity (滚筒容积) : 600L
Drum Running Speed (滚筒转速) : 100RPM
Dimension (底座尺寸) : 137*130*75CM
Durm Size (滚筒尺寸) : R:110CM L:130CM



FH-350/FH-400

Weight (重量) : 328KG/348KG
Power (马力) : Diesel 6HP
Drum Capacity (滚筒容积) : 350L/400L
Drum Running Speed (滚筒转速) : 100RPM
Packing Size (包装尺寸) : 200*100*120CM



JW350E

Weight (重量) : 290KG
Power (马力) : 380V 3KW
Drum Capacity (滚筒容积) : 350L
Drum Running Speed (滚筒转速) : 100RPM
Dimension (尺寸) :
R: 112CM H: 107CM



FH-500

Weight (重量) : 380KG
Power (马力) : Diesel 186F
Drum Capacity (滚筒容积) : 500L
Drum Running Speed (滚筒转速) : 20/MIN
Packing Size (包装尺寸) : 220*120*140CM



JW750E

Weight (重量) : 608KG
Power (马力) : 380V 11KW
Drum Capacity (滚筒容积) : 750L
Drum Running Speed (滚筒转速) : 100RPM
Dimension (尺寸) :
R: 148.5CM H: 125CM



CONCRETE MIXER/ 混凝土搅拌机



JE300E

Weight (重量): 40KG
Power (马力): 0.5KW Single Phase Motor
Drum Capacity (滚筒容积): 140L(5CF)
Drum Diameter (滚筒直径): 24
Batch Output (批量输出): 275LBS
Packing Size (包装尺寸): 70*64*65CM



JE300G

Weight (重量): 50KG
Power (马力): Gasoline Engine 5HP
Drum Capacity (滚筒容积): 140L(5CF)
Drum Diameter (滚筒直径): 24
Batch Output (批量输出): 275LBS
Packing Size (包装尺寸): 103*69*69CM



JE140

Weight (重量): 95KG
Charging capacity (容积): 140L
Voltage/ Hz (电压): 220v/50Hz
Speed of mixing drum (转速): 2800r/min
Power type (动力): Electric Motor/Gasline
Motor power (马力): 550W/5HP
Transmission way (驱动方式): Gear wheel 齿轮
Lock device (锁扣方式): Manual or Foot steps 脚踏
Type of the tires (轮胎): 8"X 1.75
Overall Dimension (尺寸): 89*67*44CM



DUMPER 翻斗车



FH15

Payload Capacity (有效荷载力): 1500KG
Engine Brand (发动机品牌): Desel Changchai 16HP
Max Capacity of Bucket (铲斗最大容量): 840L
Displacement of Gear Pump (齿轮泵排量): 18ML/H
Flow Rate of Multi-way Valve (多路阀流量): 63L/MIN
Max Speed (最大速度): 24KM/H
Minimum Trning Radius (最低转向器半径): 3.5M
Max Grade Ability (最大爬坡能力): 21%
Drive Means (驱动方式): Two wheel drive
Wheel Base (轴距): 150CM
Tread (踏板): 126CM
Total Weight (总重量): 1050KG



FH10



FH 20 HYDRAULIC



FH30 HYDRAULIC



ZL08



STEEL CUTTER & BENDER

钢筋切断机 / 钢筋弯曲机

AUTO SETTING ANGLE



GQ40/50

Weight (重量)	330KG	378KG
Plain Carbon Steel (普通圆钢)	φ 32MM	φ 45MM
II-Grade Deformed Steel Bar(II螺纹钢)	φ 25MM	φ 38MM
The Frequency Incision (切口频率)	32R.P.M.	28R.P.M.
Power / Voltage (功率 / 电压)	3KW / 380V	4KW / 380V
Dimension (包装尺寸)	119CM*45CM*68CM	128CM*48CM*72CM



GW42



Weight (重量) : 258KW/240KG
Plain Carbon Steel (普通圆钢) : φ 40MM
II-Grade Deformed Steel Bar (II螺纹钢) : φ 32MM
Working Rotational Speed (工作转速) : 5-15R.P.M.
Power / Voltage (功率 / 电压) : 3KW / 380V
Dimension (包装尺寸) : 905*810*945MM



GW40/50

Weight (重量)	240KG	348KG
Plain Carbon Steel (普通圆钢)	φ 32MM	φ 45MM
II-Grade Deformed Steel Bar(II螺纹钢)	φ 25MM	φ 38MM
Working Rotational Speed (工作转速)	8-10R.P.M.	26-8R.P.M.
Power / Voltage (功率 / 电压)	3KW / 380V	4KW / 380V
Dimension (包装尺寸)	76CM*76CM*71CM	100CM*75CM*73CM



GW50A



Weight (重量) : 390KG/365KG
Plain Carbon Steel (普通圆钢) : φ 45MM
II-Grade Deformed Steel Bar (II螺纹钢) : φ 38MM
Working Rotational Speed (工作转速) : 5-15R.P.M.
Power / Voltage (功率 / 电压) : 4KW / 380V
Dimension (包装尺寸) : 1020*825*950MM



GQ40G/50G

Weight (重量)	330KG	378KG
Plain Carbon Steel (普通圆钢)	φ 36MM	φ 45MM
II-Grade Deformed Steel Bar(II螺纹钢)	φ 28MM	φ 38MM
The Frequency Incision (切口频率)	32R.P.M.	28R.P.M.
Power / Voltage (功率 / 电压)	3KW / 380V	4KW / 380V
Dimension (包装尺寸)	119CM*45CM*68CM	128CM*48CM*72CM



GF22



Max of II Grade Deformed Steel
Bar: 4-18mm
Speed: 24r/min
Power: 1.5kw
Cutting way
Packing Data: Carton
Packing size (包装尺寸) : 905*810*990MM
N.W.: 120KG/ G.W:145KG



GW40G/50G

Weight (重量)	258KG	390KG
Plain Carbon Steel (普通圆钢)	φ 40MM	φ 45MM
II-Grade Deformed Steel Bar(II螺纹钢)	φ 32MM	φ 38MM
The Frequency Incision (切口频率)	5-15R.P.M.	5-15R.P.M.
Power / Voltage (功率 / 电压)	3KW / 380V	4KW / 380V
Dimension (包装尺寸)	905*810*945MM	1020*825*950MM



GT4-12 5.5KW/7.5KW



Power(动力) : 5.5KW / 7.5KW
II-G Deformed Steel Bar (II号螺纹钢) : φ 8MM / φ 10MM
Cutting Way(切断方式) : Auto
N.W: 268KG / 288KW
G.W: 298KG / 318KG
Packing Size: 180*60*80CM

STEEL CUTTER

钢筋切断机

NINGBO FEIHU MACHINERY CO.,LTD



RC-16



Voltage (电压): 220V/110V
Wattage(空载功率): 690W/760W
Gross weight (毛重): 13kg
Machine weight (净重): 8kg
Cutting speed (切断速度): 2.5-3.0s
Max rebar (最大钢筋切割直径): 16mm
Min.rebar (最小钢筋切割直径): 4mm
Carton size (外包尺寸): 510*230*150mm
Machine size (机器尺寸): 460*270*115mm



RC-20/RC-22/RC-25



Voltage (电压)	220V/110V	220V/110V	220V/110V
Wattage(空载功率)	830W/900W	850W/1170W	1300W/1440W
Gross weight (毛重)	18.3kg	21.5kg	32kg
Machine weight (净重)	13kg	15kg	24.5kg
Cutting speed (切断速度)	3.0-3.5s	3.5-4.5s	5s
Max rebar (最大钢筋切割直径)	20mm	22mm	25mm
Min.rebar (最小钢筋切割直径)	4mm	4mm	4mm
Carton size (外包尺寸)	480*195*280mm	485*190*330mm	565*230*345mm
Machine size (机器尺寸)	410*115*220mm	420*120*230mm	480*150*255mm



NRC-20



Voltage (电压): 220V/110V
Wattage(空载功率): 800W/850W
Gross weight (毛重): 17kg
Machine weight (净重): 12.5kg
Cutting speed (切断速度): 3.0-3.5s
Max rebar (最大钢筋切割直径): 20mm
Min.rebar (最小钢筋切割直径): 4mm
Carton size (外包尺寸): 575*280*165mm
Machine size (机器尺寸): 500*130*140mm



PT-25



Crimping force (出力): 6T
Crimping range (使用范围): Φ 13-25mm
Crimping head (压接头部): SU13 SU20 SU25
Stroke (行程): 45mm
Length (长度): 260mm
Weight (重量): 9.5kg

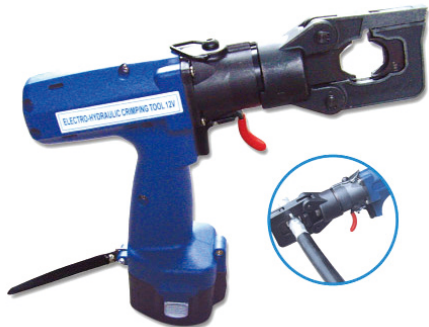

HC-185



Crimping power(出力): 5.5ton
Crimping size (压接范围): 10-185mm²
10,1,25,35,50,70,95,120,150,185,square mm
Machine size (机器尺寸): 315*80*235mm
Carton size (外包尺寸): 400*135*360mm
Machine weight (毛重): 11kg
Machine weight (重量): 3.2kg
Voltage (电压): 12V
Battery (电池): Ni-Mh



RB-16



Voltage (电压): 220V/110V
Wattage(空载功率): 750W/800W
Gross weight (毛重): 16.5kg
Machine weight (净重): 15kg
Cutting speed (切断速度): 5.0s
Max rebar (最大钢筋切割直径): 16mm
Min.rebar (最小钢筋切割直径): 4mm
Carton size (外包尺寸): 670*250*245mm
Machine size (机器尺寸): 600*170*200mm
Bend Angle (弯曲角度): 0-130°



MHP-20



Voltage (电压): 220V/110V
Wattage(空载功率): 800W/900W
Gross weight (毛重): 20kg
Machine weight (净重): 12kg
Punch speed (冲孔速度): 2-3s
Max round orifice (最大直径): 20mm
Min.round orifice (最小直径): 6mm
Punch thickness (最大板厚): 6mm
Carton size (外包尺寸): 545*310*180mm
Machine size (机器尺寸): 500*195*100mm



RB-25/RB-32



Voltage (电压):	220V/110V	220V/110V
Wattage(空载功率):	1600W/1700W	3000W
Gross weight (毛重):	109kg	203kg
Machine weight (净重):	91kg	175kg
Max rebar(最大钢筋切割直径):	25mm	32mm
Min.rebar(最小钢筋切割直径):	6mm	6mm
Carton size (外包尺寸):	500*555*505mm	600*580*470mm
Machine size (机器尺寸):	450*500*440mm	650*650*730mm
Bend Angle (弯曲角度):	0-180°	0-180°

ENGINE

汽油机

VIBRATION MOTOR

混凝土振动器



Diesel KAMA 178F



Honda GX35



Honda GX100



Honda GX160



Honda GX270



Honda GX390



Robin EH12



Robin ER12



Robin Ey20



Robin Ey28

ZW-3.5

Quiver Frequency (振动频率) : 2840R.P.M.
Exciting Force (激振力) : 350KGF
Rated Voltage (电压) : 220V/380V
Rated Current (电流) : 5.94/1.9A
Motor Power (功率) : 0.75KW
Packing Size (包装尺寸) : 34*20*22CM

ZW-5

Quiver Frequency(振动频率) : 2840R.P.M.
Exciting Force (激振力) : 500KGF
Rated Voltage (电压) : 220V/380V
Rated Current (电流) : 8.74/2.44A
Motor Power (功率) : 1.1KW
Packing Size (包装尺寸) : 42*23*25 CM



ZW-7

Quiver Frequency (振动频率) : 2840R.P.M.
Exciting Force (激振力) : 700KGF
Rated Voltage (电压) : 380V
Rated Current (电流) : 3.24A
Motor Power (功率) : 1.5KW
Packing Size (包装尺寸) : 42*23*25 CM

ZW-10

Quiver Frequency(振动频率) : 2840R.P.M.
Exciting Force (激振力) : 980KGF
Rated Voltage (电压) : 380V
Rated Current (电流) : 4.53A
Motor Power (功率) : 2.2KW
Packing Size (包装尺寸) : 48*27*38CM

VIBRATION MOTOR

混凝土振动器



ZN-F

Power(功率) : 2.2KW
Voltage(电压) : 220V
Motor Frequency(频率) : 50HZ

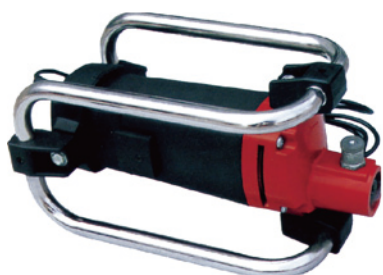

Z1N Japanese Type

Power (功率) : 1.1KW, 1.5KW, 1.6KW, 1.8KW
Voltage (电压) : 220V/380V/110V
Motor Frequency (频率) : 50~60HZ



ZN-T1

功率: 1.5KW, 2.2KW
电压: 220V, 380V
Motor Frequency (频率) : 50~60HZ



ZN-R

功率: 1.4KW, 2.2KW
电压: 42V, 220V
Motor Frequency (频率) : 50~60HZ



ZN-A Chinese Type

Power (功率) : 1.1KW, 1.5KW, 2.2KW
Voltage (电压) : 220V/380V
Motor Frequency (频率) : 50~60HZ
Packing Size(尺寸) : 38*29*30CM



ZN-G Japanese Type

Power (功率) : 1.1KW, 1.5KW, 2.2KW
Voltage (电压) : 220V/380V
Motor Frequency (频率) : 50~60HZ
Packing Size(尺寸) : 40*28*30CM

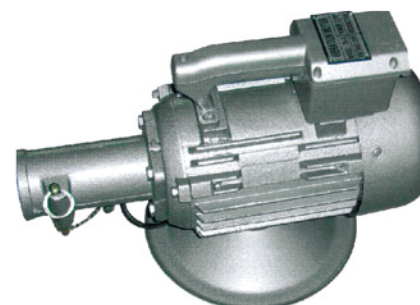

ZN-G Malaysian Type

Power/ 功率 : 1.1KW, 1.5KW, 2.2KW
Voltage/ 电压 : 220V/380V
Motor Frequency/ 电机频率 : 50~60HZ
Packing Size(尺寸) : 40*28*30CM



ZN-C Japanese Type

Power (功率) : 2.0HP
Voltage (电压) : 220V
Motor Frequency (频率) : 50~60HZ
Packing Size(尺寸) : 39*28*30CM

CONCRETE VIBRATOR

混凝土振动棒

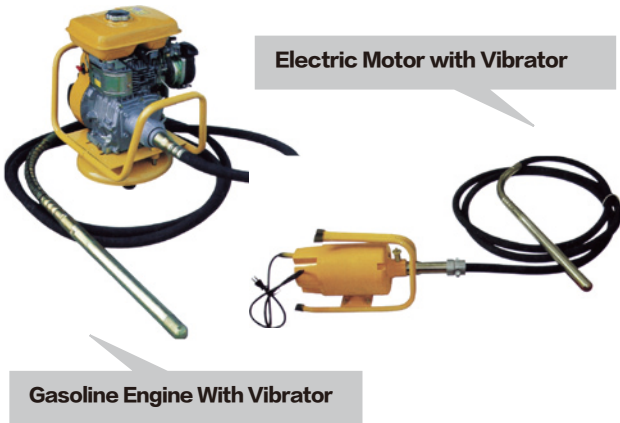

Gasoline Engine With Vibrator

Engine Model (发动机型号): Robin EY20
Vibrator Frequency (振动频率): 183-200HZ
Amplitude (振幅): 0.9MM
Frame: E, Coupling: Japanese Type
Diamete Of Vibrator (振动棒直径): 28mm, 32mm, 38mm, 45mm
Length (长度): 4-6m, standard: 6m



CONCRETE VIBRATOR

Diamete of Vibrator (振动棒直径): 28mm, 32mm, 38mm
Length (长度): 4-6m
Standard (标准): 6m



Water Pump with Robin Engine

Power (动力): Gasoline Engine 5.0-5.5hp
Frame (支架): E
Coupling (接口): Japanese Type
Hose Length (软管长度): 6m
Discharge Diameter (出水口): 2#-3#
Maximum Lift (最大提升): 16m
Maximum Capacity (最大工作量): 1200L/min
Packing Size (包装尺寸): 51*35*46CM/54*40*46CM



WATER PUMP/ 水泵 WP-50, WP-80

Power (马力): Gasoline Engine 5.0-5.5hp
Outlet Connection (出水口): 2#-3#
Inlet Connection (进水口): 2#-3#



Poke Stick Vibrator

Power (动力): Honda GX35 2HP
Bar Diameter (振动棒直径): 35mm, 38mm, 45mm
Bar Length (长度): 1-2m
Packing Size (包装尺寸): 123*26*27CM



Hand Insertion Vibrator

Type (型号): ZPI-35
Motor Power (电机功率): 0.55kw, 0.60kw, 0.80kw
Voltage (电压): 220V/110V
Frequency (频率): 50Hz
Bar Diamete (振动棒直径): 35mm, 45mm
Amplitude (振幅): 0.5mm
Bar Length (振动棒长度): 1-2m

Back-Hold Vibrator

Diamete of Vibrator (振动棒直径): 28mm, 32mm, 38mm
Length (长度): 4-6m
Standard (标准): 6m



Turkey Type Vibrator



ZN-T2:0.75KW

Russia Type Vibrator

HEAD: 51MM
LENGTH: 3M/4.5M/6M



SPARE PARTS/ 接头配件

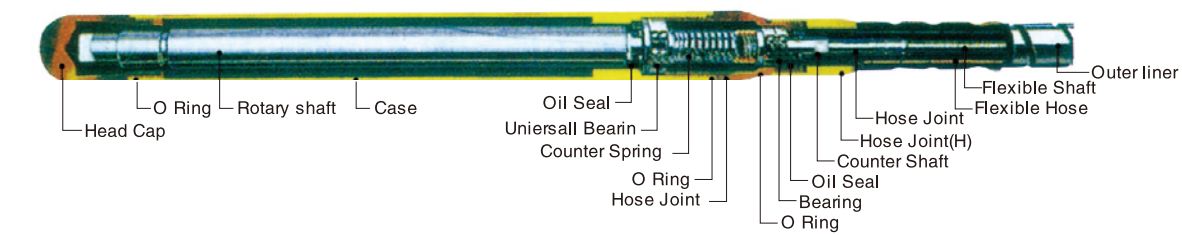

Vibrator head

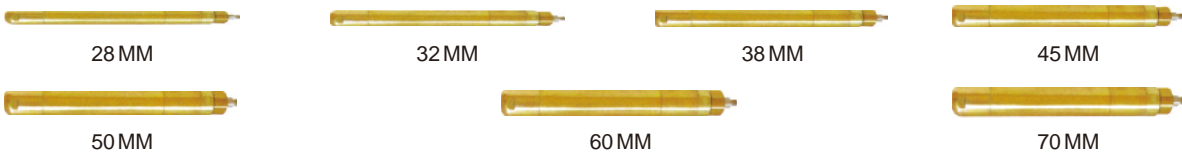

Specification

Model (型号)	Bar diameter (振动棒直径)	Motor powerV (电机功率)	ibration Frequency (振动频率)	Amplitude (振幅)	Length of Shaft (轴长度)
CV -28	28MM	1.1/1.5KW 1.5-2HP	183-200HZ	0.8MM	Standard : 6M 4-7M : Available
CV -32	32MM			0.85MM	
CV -38	38MM			0.9MM	
CV -45	45MM			1.0MM	
CV -50	50MM			1.0MM	
CV -60	60MM			1.1MM	
CV -70	70MM			1.2MM	

No	Part Name	Q'ty
1	Head Cap	1
2	O-Ring	3
3	Case	1
4	Bearing Hoder	1
5	Hose Joint Case	1
6	O-Ring	1
7	Rotary Shaft	1
8	Oil Seal	1
9	Bearing	1
10-A	Counter Spring	1
10-B	Counter Spring Bolt	2
11	Bearing	1
12	Oil Seal	1
13	Counter Shaft	1
14	Hose Joint Coupling " H "	1
15	Outerliner	1
16	Stop Ring	1
17	Shaft Joint	2
18	Flexile Shaft	1
19	Flexile Hose	1
20-A	Hose Joint Coupling " M "	1
20-B	Hose Joint Coupling Band	1
20-C	Band Bolt	2
21	Shaft Joint Key	1

Parts List

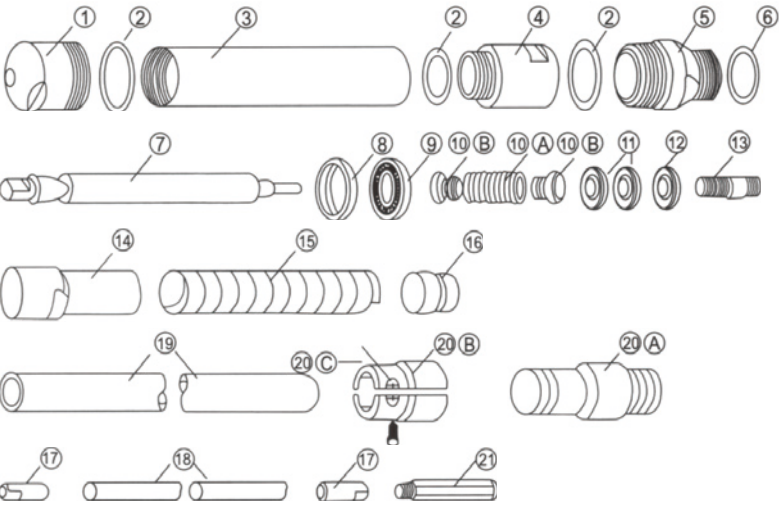

Robin Engine with Frame
E&Japan Type Coupling



Robin Engine with Frame
C&Malaysia Type Coupling



Diesel Engine with Frame
F&Malaysia Type Coupling



Frame G



Frame E



Frame D



EH-G2



EH-H2



EH-A1



EH-A2



EH-B2



EH-B1



EH-D1



EH-D2



EH-E2



SJ-D1



EC-C1



EC-C2



EC-C3



EH-C1



EH-F2



JC-K1



JC-K2



JC-K3B



JC-K5



JC-K3&K4



JC-K6



Tapered Stem



Wing Nut



Universal
Hose End3/4"



Female
End3/4"



Double Bolt
Hose Clamp